



Carbide Inserts

CCMT

80° Diamond-positive Rake With Hole & Chip Breaker

- Single sided.
- 7° relief angle.
- Use for turning.
- Use for light cuts.

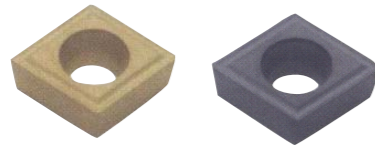

Insert Standard		Size			Grade
ANSI Standard	ISO Standard	I.C.	T.	R.	
CCMT-21.51	CCMT-060204	1/4"	3/32"	1/64"	C2
CCMT-21.51	CCMT-060204	1/4"	3/32"	1/64"	C5 C6
CCMT-21.51	CCMT-060204	1/4"	3/32"	1/64"	TIN COATED
CCMT-21.52	CCMT-060208	1/4"	3/32"	1/32"	C2
CCMT-21.52	CCMT-060208	1/4"	3/32"	1/32"	C5 C6
CCMT-21.52	CCMT-060208	1/4"	3/32"	1/32"	TIN COATED
CCMT-32.51	CCMT-09T304	3/8"	5/32"	1/64"	C2
CCMT-32.51	CCMT-09T304	3/8"	5/32"	1/64"	C5 C6
CCMT-32.51	CCMT-09T304	3/8"	5/32"	1/64"	TIN COATED
CCMT-32.52	CCMT-09T308	3/8"	5/32"	1/32"	C2
CCMT-32.52	CCMT-09T308	3/8"	5/32"	1/32"	C5 C6
CCMT-32.52	CCMT-09T308	3/8"	5/32"	1/32"	TIN COATED

DCMT

55° Diamond-positive Rake With Hole & Chip Breaker

- Single-sided.
- 7° relief angle.
- Use for turning.
- Use for medium cuts.

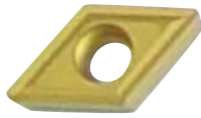

Insert Standard		Size			Grade
ANSI Standard	ISO Standard	I.C.	T.	R.	
DCMT-21.51	DCMT-070204	1/4"	3/32"	1/64"	C2
DCMT-21.51	DCMT-070204	1/4"	3/32"	1/64"	C5 C6
DCMT-21.51	DCMT-070204	1/4"	3/32"	1/64"	TIN COATED
DCMT-21.52	DCMT-070208	1/4"	3/32"	1/32"	C2
DCMT-21.52	DCMT-070208	1/4"	3/32"	1/32"	C5 C6
DCMT-21.52	DCMT-070208	1/4"	3/32"	1/32"	TIN COATED
DCMT-32.51	DCMT-11T304	3/8"	5/32"	1/64"	C2
DCMT-32.51	DCMT-11T304	3/8"	5/32"	1/64"	C5 C6
DCMT-32.51	DCMT-11T304	3/8"	5/32"	1/64"	TIN COATED
DCMT-32.52	DCMT-11T308	3/8"	5/32"	1/32"	C2
DCMT-32.52	DCMT-11T308	3/8"	5/32"	1/32"	C5 C6
DCMT-32.52	DCMT-11T308	3/8"	5/32"	1/32"	TIN COATED

DNMG

55° Diamond-negative Rake Insert With Chip Control

- Chip control on both sides.
- Feed range .010 to .028" per revolution.
- 0° relief angle.



Insert Standard		Size			Grade
ANSI Standard	ISO Standard	I.C.	T.	R.	
DNMG-322	DNMG-110408	3/8"	1/8"	1/32"	C2
DNMG-322	DNMG-110408	3/8"	1/8"	1/32"	C5 C6
DNMG-322	DNMG-110408	3/8"	1/8"	1/32"	TIN COATED
DNMG-431	DNMG-150404	1/2"	3/16"	1/64"	C2
DNMG-431	DNMG-150404	1/2"	3/16"	1/64"	C5 C6
DNMG-431	DNMG-150404	1/2"	3/16"	1/64"	TIN COATED
DNMG-432	DNMG-150408	1/2"	3/16"	1/32"	C2
DNMG-432	DNMG-150408	1/2"	3/16"	1/32"	C5 C6
DNMG-432	DNMG-150408	1/2"	3/16"	1/32"	TIN COATED

RNG

Round-negative Rake Insert

- For chip control use mechanical chipbreaker.
- Feed range from .003 to .025" per revolution.
- 0° relief angle.



RNG Continued

Insert Standard		Size			Grade
ANSI Standard	ISO Standard	I.C.	T.	R.	
RNG-32	RNGN-090300	3/8"	1/8"		C2
RNG-32	RNGN-090300	3/8"	1/8"		C5 C6
RNG-32	RNGN-090300	3/8"	1/8"		TIN COATED
RNG-42	RNGN-120300	1/2"	1/8"		C2
RNG-42	RNGN-120300	1/2"	1/8"		C5 C6
RNG-42	RNGN-120300	1/2"	1/8"		TIN COATED
RNG-43	RNGN-120400	1/2"	3/16"		C2
RNG-43	RNGN-120400	1/2"	3/16"		C5 C6
RNG-43	RNGN-120400	1/2"	3/16"		TIN COATED

RNMA

Round-negative Rake Insert

- Use for turning, plunging and profiling.
- Precision ground top and bottom.
- Feed range from .003 to .025" per revolution.



Insert Standard		Size			Grade
ANSI Standard	ISO Standard	I.C.	T.	R.	
RNMA-32	RNMA-090300	3/8"	1/8"		C2
RNMA-32	RNMA-090300	3/8"	1/8"		C5 C6
RNMA-32	RNMA-090300	3/8"	1/8"		TIN COATED
RNMA-43	RNMA-120400	1/2"	3/16"		C2
RNMA-43	RNMA-120400	1/2"	3/16"		C5 C6
RNMA-43	RNMA-120400	1/2"	3/16"		TIN COATED
RNMA-64	RNMA-190600	3/4"	1/4"		C2
RNMA-64	RNMA-190600	3/4"	1/4"		C5 C6
RNMA-64	RNMA-190600	3/4"	1/4"		TIN COATED

RNMG

Round- Negative Rake With Chip Control

- Use for turning, plunging and profiling.
- Moulded chip control both sides.
- Feed range .010 to 0.28" per revolution.
- 0° relief angle.



Insert Standard		Size			Grade
ANSI Standard	ISO Standard	I.C.	T.	R.	
RNMG-32	RNMG-090300	3/8"	1/8"		C2
RNMG-32	RNMG-090300	3/8"	1/8"		C5 C6
RNMG-32	RNMG-090300	3/8"	1/8"		TIN COATED
RNMG-43	RNMG-120400	1/2"	3/16"		C2
RNMG-43	RNMG-120400	1/2"	3/16"		C5 C6
RNMG-43	RNMG-120400	1/2"	3/16"		TIN COATED
RNMG-64	RNMG-190600	3/4"	1/4"		C2
RNMG-64	RNMG-190600	3/4"	1/4"		C5 C6
RNMG-64	RNMG-190600	3/4"	1/4"		TIN COATED

SEAN

• 20° relief angle

- Medium milling applications.

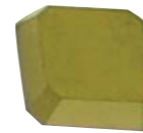

Insert Standard		Size			Grade
ANSI Standard	ISO Standard	I.C.	T.	R.	
SEAN-42-AFN	SEAN-120305	1/2"	.125"	.055"	C2
SEAN-42-AFN	SEAN-120305	1/2"	.125"	.055"	C5 C6
SEAN-42-AFN	SEAN-120305	1/2"	.125"	.055"	TIN COATED
SEAN-42-AFTN	SEAN-120305	1/2"	.125"	.055"	C2
SEAN-42-AFTN	SEAN-120305	1/2"	.125"	.055"	C5 C6
SEAN-42-AFTN	SEAN-120305	1/2"	.125"	.055"	TIN COATED
SEAN-43-AFN	SEAN-120405	1/2"	.187"	.055"	C2
SEAN-43-AFN	SEAN-120405	1/2"	.187"	.055"	C5 C6
SEAN-43-AFN	SEAN-120405	1/2"	.187"	.055"	TIN COATED
SEAN-43-AFTN	SEAN-120405	1/2"	.187"	.055"	C2
SEAN-43-AFTN	SEAN-120405	1/2"	.187"	.055"	C5 C6
SEAN-43-AFTN	SEAN-120405	1/2"	.187"	.055"	TIN COATED

SEC

- 20° relief angle.
- 45° flatted corners.

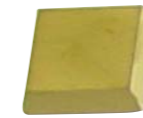

Insert Standard		Size			Grade
ANSI Standard	ISO Standard	I.C.	T.	R.	
SEC-422	SECN-120308	1/2"	.125"	.031"	C2
SEC-422	SECN-120308	1/2"	.125"	.031"	C5 C6
SEC-422	SECN-120308	1/2"	.125"	.031"	TIN COATED
SEC-533	SECN-160412	5/8"	.187"	.046"	C2
SEC-533	SECN-160412	5/8"	.187"	.046"	C5 C6
SEC-533	SECN-160412	5/8"	.187"	.046"	TIN COATED
SEC-633	SECN-190412	3/4"	.187"	.046"	C2
SEC-633	SECN-190412	3/4"	.187"	.046"	C5 C6
SEC-633	SECN-190412	3/4"	.187"	.046"	TIN COATED

SEKN

- 20° relief angle.
- Medium milling applications.

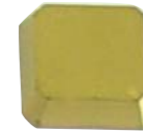

Insert Standard		Size			Grade
ANSI Standard	ISO Standard	I.C.	T.	R.	
SEKN42 AFTN	SEKN-120305	1/2"	.125"	.071"	C2
SEKN42 AFTN	SEKN-120305	1/2"	.125"	.071"	C5 C6
SEKN42 AFTN	SEKN-120305	1/2"	.125"	.071"	TIN COATED
SEKN43 AFN	SEKN-120405	1/2"	.187"	.071"	C2
SEKN43 AFN	SEKN-120405	1/2"	.187"	.071"	C5 C6
SEKN43 AFN	SEKN-120405	1/2"	.187"	.071"	TIN COATED
SEKN43 AFTN	SEKN-120405	1/2"	.187"	.071"	C2
SEKN43 AFTN	SEKN-120405	1/2"	.187"	.071"	C5 C6
SEKN43 AFTN	SEKN-120405	1/2"	.187"	.071"	TIN COATED

SNG

Square-negative Rake Insert

- Use mechanical chipbreakers-Style CBS.
- Feed range from .003 to .030" per revolution.
- 0° relief angle.



Insert Standard		Size			Grade
ANSI Standard	ISO Standard	I.C.	T.	R.	
SNG-321	SNG-090304	3/8"	1/8"	1/64"	C2
SNG-321	SNG-090304	3/8"	1/8"	1/64"	C5 C6
SNG-321	SNG-090304	3/8"	1/8"	1/64"	TIN COATED
SNG-322	SNG-090308	3/8"	1/8"	1/32"	C2
SNG-322	SNG-090308	3/8"	1/8"	1/32"	C5 C6
SNG-322	SNG-090308	3/8"	1/8"	1/32"	TIN COATED
SNG-323	SNG-090312	3/8"	1/8"	3/64"	C2
SNG-323	SNG-090312	3/8"	1/8"	3/64"	C5 C6
SNG-323	SNG-090312	3/8"	1/8"	3/64"	TIN COATED
SNG-422	SNG-120308	1/2"	1/8"	1/32"	C2
SNG-422	SNG-120308	1/2"	1/8"	1/32"	C5 C6
SNG-422	SNG-120308	1/2"	1/8"	1/32"	TIN COATED
SNG-423	SNG-120312	1/2"	1/8"	3/64"	C2
SNG-423	SNG-120312	1/2"	1/8"	3/64"	C5 C6
SNG-423	SNG-120312	1/2"	1/8"	3/64"	TIN COATED
SNG-432	SNG-120408	1/2"	3/16"	1/32"	C2
SNG-432	SNG-120408	1/2"	3/16"	1/32"	C5 C6
SNG-432	SNG-120408	1/2"	3/16"	1/32"	TIN COATED
SNG-433	SNG-120412	1/2"	3/16"	3/64"	C2
SNG-433	SNG-120412	1/2"	3/16"	3/64"	C5 C6
SNG-433	SNG-120412	1/2"	3/16"	3/64"	TIN COATED
SNG-434	SNG-120416	1/2"	3/16"	1/16"	C2
SNG-434	SNG-120416	1/2"	3/16"	1/16"	C5 C6
SNG-434	SNG-120416	1/2"	3/16"	1/16"	TIN COATED
SNG-632	SNG-190408	3/4"	3/16"	1/32"	C2
SNG-632	SNG-190408	3/4"	3/16"	1/32"	C5 C6
SNG-632	SNG-190408	3/4"	3/16"	1/32"	TIN COATED
SNG-634	SNG-190416	3/4"	3/16"	1/16"	C2
SNG-634	SNG-190416	3/4"	3/16"	1/16"	C5 C6
SNG-634	SNG-190416	3/4"	3/16"	1/16"	TIN COATED

SNMG

Square-negative Rake Insert With Chip Control

- Chip control on both sides.
- Feed range .01 to .028" per revolution.
- 0° relief angle.



Insert Standard		Size			Grade
ANSI Standard	ISO Standard	I.C.	T.	R.	
SNMG-322	SNMG-090308	3/8"	1/8"	1/32"	C2
SNMG-322	SNMG-090308	3/8"	1/8"	1/32"	C5 C6
SNMG-322	SNMG-090308	3/8"			