

Reversing Tapping Heads & Attachments

Reversing Tapping Heads & Attachments have been the industry standard of the metalworking industry. Even inexperienced operators can consistently produce gage perfect threads at spindle speeds up to 2000 rpm. Their design, compact size and ease of set-up permit universal application. Standard right hand tapping torque control with reversing stop arm. Collets are required for use with Tapping Heads.



TH-30 attachments require 1 each .094-.177 and .177-.256 Collets

Model No.	Capacity in Steel	Mounts
TH-30 #0-1/4"	B16 (M1.4-M7)	#6JT

TH-50 attachments require 1 each .139-.257 and .253-.383 Collets

Model No.	Capacity in Steel	Mounts
TH-50 #6-1/2"	B16 (M3-M12)	#6JT

TH-70 attachments require 1 each .176-.383 and .280-.500 Collets

Model No.	Capacity in Steel	Mounts
TH-70 #10-5/8"	B22 (M5-M16)	20mm thread

Collets For Tapping Heads

Model No.	Capacity
R3,30TC/DC	.094-.177"
SPD3	.177-.256"
R5,50TC/DC	.139-.257"
SPD5	.253-.383"
R7,70TC/DC	.176-.383"
SPD7	.328-.500"
R7	.5-.75"



SPD5

Horizontal-Vertical Tightening Fixtures

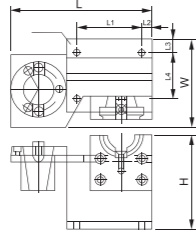

Model No.	Taper	L	L1	L2	L3	L4	H	W
ETTF-30CAT	CAT 30	210	95	16	17.5	65	139	110
		8.26"	3.74"	.62"	.62"	2.55"	5.47"	3.93"
ETTF-40CAT	CAT 40	210	95	16	17.5	65	139	110
		8.26"	3.74"	.62"	.62"	2.55"	5.47"	3.93"
ETTF-50CAT	CAT 50	28	112	24	22	106	196	150
		11.02"	4.40"	.94"	.86"	4.17"	7.71"	5.90"
ETTF-30DAT	DAT 30	210	95	16	17.5	65	139	110
		8.26"	3.74"	.62"	.62"	2.55"	5.47"	3.93"
ETTF-40DAT	DAT 40	275	95	16	17.5	65	139	110
		8.26"	3.74"	.62"	.62"	2.55"	5.47"	3.93"
ETTF-50DAT	DAT 50	210	112	24	22	106	196	150
		11.02"	4.40"	.94"	.86"	4.17"	7.71"	5.90"

Spindle Taper Wipers

Economy wiper For all 40 and 50 tapers Maintains spindle accuracy and contact



Unit:mm/inches

Model No.	Taper	O.A.L.	Taper Length	Handle Length	Handle Dia.	Taper Max.Dia.
ESTW-30	ISO 30	170	60	110	24	32
		6.69"	2.36"	4.33"	1"	1.25"
ESTW-40	ISO 40	188	78	110	24	45
		7.40"	3.07"	4.33"	1"	1.77"
ESTW-50	ISO 50	240	120	120	30	70
		9.44"	4.72"	4.72"	1.181"	2.75"

Heavy Duty Keyless Drill Chucks

Features:
 • For machinery where gripping power and accuracy are a must for use with press, JIG Bore,milling machine and production drilling equipment.
 • Easily used by hand.
 • Hardened and ground.
 • Accuracy:0.12mm/0.004"



Model No.	Capacity mm	Taper mounted	Model No.	Capacity	Taper mounted
DCTA-10	1-10	B12	DCTA-3/8	1/32"-3/8"	JT2
DCTA-13	1-13	B16	DCTA-3/8B	1/32"-3/8"	JT33
DCTA-16	3-16	B16	DCTA-1/2A	1/32"-1/2"	JT2
DCTA-16B	3-16	B18	DCTA-1/2B	1/32"-1/2"	JT6
DCTA-20	3-20	B22	DCTA-1/2C	1/32"-1/2"	JT33
			DCTA-5/8	1/8"-5/8"	JT6
			DCTA-5/8B	1/8"-5/8"	JT3
			DCTA-3/4	1/8"-3/4"	JT3

NEW Keyless Drill Chuck Tolerance:0.0024"/0.06mm TIR

Features:
 • Designed specifically for high accuracy applications on either conventional or CNC equipment.
 • Self-tightening for high-clamping torque.
 • For heavy-duty use.



Model No.	Chuck Capacity	Tapered Mount	Model No.	Chuck Capacity	Tapered Mount
DCJM013H	1/64"-1/8"	J0	DCMJM013H	0.2-3mm	B6
DCJM014H	1/64"-5/32"	J1	DCMJM014H	0.2-4mm	B10
DCJM016H	1/64"-1/4"	J1	DCMJM016H	0.2-6mm	B10
DCJM018H	1/64"-5/16"	J2	DCMJM018H	0.2-8mm	B12
DCJM0110H	1/64"-3/8"	J2	DCMJM0110H	0.2-10mm	B12
DCJM0113H	1/64"-1/2"	J33	DCMJM0113H	0.2-13mm	B16
DCJM0116H	1/64"-5/8"	J6	DCMJM0116H	0.2-16mm	B18

NEW Keyless Drill Chucks With Integral Shanks

Features:
 • more compact
 • Greater accuracy and rigidity
 • Chuck Capacity : 1/32-1/2"
 • Max rpm 7,000



Model No.	Chuck Capacity	Model No.	Chuck Capacity	Shank Type
KC2MT-1/2	1/32"-1/2"	KC2MT-13M	0.2-13mm	2MT
KC3MT-1/2	1/32"-1/2"	KC3MT-13M	0.2-13mm	3MT
KC4MT-1/2	1/32"-1/2"	KC4MT-13M	0.2-13mm	4MT
KCR8-1/2	1/32"-1/2"	KCR8-13M	0.2-13mm	R8

NEW Keyless Drill Chuck Arbor With Integral Shanks

Features:
 • The shorter length and one-piece construction makes for a more rigid design than a separate chuck and arbor.
 • The integral shank eliminates the possibility of the chuck slipping on an arbor.
 • Max rpm 6,500
 • Chuck Capacity : 1/32-1/2"



Model No.	Capacity	Model No.	Capacity	Shank Type
KCC40-1/2	1/32-1/2"	KCC40-13	1-13mm	CAT 40
KCC40-5/8	1/16-5/8"	KCC40-16	1-16mm	CAT 40
KCC50-5/8	1/16-5/8"	KCC50-16	1-16mm	CAT 50
KCB40-1/2	1/32-1/2"	KCB40-13	1-13mm	BT 40
KCB40-5/8	1/16-5/8"	KCB40-16	1-16mm	BT 40
KCB50-5/8	1/16-5/8"	KCB50-16	1-16mm	BT 50

Vertical 5C Collet Fixture

Uses 5C Collets
 • Mounted on ground flat base for vertical use only
 • Uses any standard 5C collet for a capacity up to 1-1/8"round
 • Also accepts hex and square collets
 • Small movement of lever opens and closes collet
 • Base: 8"L x 3"W
 • Height: 4-3/8"



Model No.:CF-A

Vertical and Horizontal 5C Collet Fixture

• Mounted on an angle plate, this fixture may be used in either a vertical or horizontal position
 • Uses any standard 5C collet, for a capacity up to 1-1/8" round
 • A small movement of the lever opens and closes the collet



Model No.:CFSCI-B

5C Spin-Index Fixture

• Spindle lock retains accuracy under load
 • 2-1/16" spindle travel provided for flute grinding
 • Guaranteed to accuracy shown
 • Hardened and precision ground spindle
 • Spindle accuracy: .0004" TIR.
 • Super time saver
 • Applicable to all milling machines, surfaces grinders and inspection equipment
 • Precision ground 36 position index plate
 • Direct indexing in ten steps, graduated in 5° increments
 • 10 vernier precision ground holes for 1° indexing
 • Front of base ground parallel to spindle axis

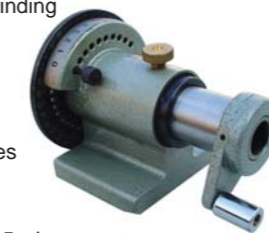

Model No.:CFSP

Specifications:	Maximum Variations
True running of dividing spindle flange surface.....	.0004"
True running of cylindrical center bore per 1".....	.0012"
Parallelism of spindle center line to base.....	.0008"
Base ground parallel to within.....	.0005"

Super Indexing Spacers

Features:
 • For milling, drilling, jig boring, and many common shop applications
 • 24 position hardened and ground index plate(15° increments) with satin chrome dial, 360° graduated ring and adjustable 10 second vernier
 • Each unit is equipped with six(6) masking plates(2,3,4,6,8, and 12 divisions)
 • Chuck center hole diameter: 6": 1.73" ;8": 2.48"
 • Includes 10" Face Plate



Specifications	Maximum Variation(inches/seconds)	Model No.	Size
Maximum Individual Spacing Error	25 seconds	ISR-6	6"
Base to Chuck Squareness(90°)	0.0008"		
Base Parallelism	0.0004"	ISR-8	8"
Chuck Concentricity	0.0005"		

Medium Duty 5C Collet Fixtures

Horizontal and Vertical
 Can be mounted and used horizontally and vertically. Collet retains positive relation to base. Can be adjusted without disturbing set up. Does not move up or down.



Model No.:CF-C

Horizontal/Vertical Collet Holding Fixture

For 5C Collets
 • Collets held dead length
 • Hardened and ground spindle two positions-heavy casting

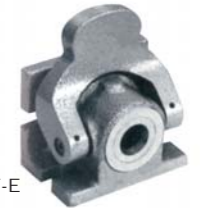

Model No.:CF-E

Horizontal And Vertical Precision 5C Collet Index Fixture

Threaded Spindle is Hardened and Ground(2-1/4-8 TPI)

• Utilizes 5C Collets
 • Single lever action activates the indexing mechanism
 • Precision ground index plate has 24 indexing locations in 15° increments, any of which can be marked for greater versatility
 • Spindle accuracy .0004" TIR



Model No.:CFCI

Specifications:	Maximum Variations
Dividing spindle concentricity.....	.0004"
Cylindrical center bore(per 1") concentricity.....	.0008"
Lateral offset of center slot of dividing spindle.....	.0008"
Center slot to dividing spindle Concentricity.....	.0008"
Spindle center line parallelism.....	.0008"
Base to face squareness.....	.0008"

Horizontal-Vertical Indexing Spacers

Features:
 • Designed for milling, drilling, jig boring, and many common shop applications
 • Precision made
 • 24-position index plate is hardened and ground
 • Satin chromed graduation ring 360 degrees and adjustable vernier plate, assure accurate reading to minutes
 • Six masking plates for 2,3,4,6,8, and 12 divisions are furnished
 • Clamping shoes lock spindle without affecting spindle alignment
 • Indexing accuracy is 25 seconds

Specifications:
 • Squareness(Base to Chuck):0.0008" max
 • Parallelism Over Face:0.0012" max
 • Concentricity of Chuck: 0.0012" max
 • Thru Bore: 6": 1.73" ; 8": 2.48"



Optional Face Plate 10"	Model No.:	Size
	OFF-10	
Optional Tailstock Available	Model No.:	OTA
	IHV-6	6"
	IHV-8	8"