

NEW Universal Dividing Head

The dividing head is designed as an accessory for milling machine and other machine tools which help the machining on dividing the workpieces into any desired angles. Moreover, with the help of the dividing head, grooves, slots, gears, helical gears, Archimedes cams and helical curves can be achieved on the machines.

Accessories:

Tailstock, Gear Bracket, Change Gear Jack, Center, Carrier, Dividing Plate Flange, Vernier Dial, 3 Jaw Chuck.



Model No.	UDH-4	UDH-5	UDH-6
Center Height mm	100mm/4"	125mm/5"	160mm/6.3"
Swivel angle of spindle from its horizontal position(upward)		≤95°	
Horizontal position (downward)		≤5°	
Rotating angle of Spindle for one complete revolution of dividing handle		9° (540 grad., 1'each)	
Min. reading of vernier		10"	
Worm gear ratio		1:40	
Taper of Spindle Bore	MT3	MT4	
Width of locating key. mm	14	18	
Diameter of short taper of spindle nose for mounting flange mm	41.275	53.975	53.975
Hole numbers on index plate	1st plate	24, 25, 28, 30, 34, 37, 38, 39, 41, 42, 43	
	2nd plate	46, 47, 49, 51, 53, 54, 57, 58, 59, 62, 66	
Change Gear	Module	1.5	
	Teeth Numbers	25, 30, 35, 40, 50, 55, 60, 70, 80, 90, 100	
Individual indexing error of the spindle for one complete revolution of dividing handle		±45"	
Cumulate error at any 1/4 periphery of spindle		±1"	

Precision Rotary Tables

- Features:
- Extra deep coolant channel
 - Dual positive action locks
 - Satin chrome dials
 - Low profile
 - 10 second vernier reading
 - Gear drive immersed in oil
 - Gear ratio is 90 to 1
 - Worm gear hardened and ground



Horizontal

Model No.	Size	Wt.
RTH-6	6"	23lbs.
RTH-8	8"	55lbs.
RTH-10	10"	82lbs.
RTH-12	12"	132lbs.

Horizontal & Vertical

Model	Size	Wt.
RTHV-8	8"	85lbs.
RTHV-10	10"	137lbs.
RTHV-12	12"	250lbs.

Each table supplied with certificate of inspection

Table Diameter	Table Height	Table Vertical Height	Height Vertical Table Center to Base	T-Slot Width	Locating Key Width	Center Bore
6"	3.0781"	-	-	.40"	.50"	2MT
8"	3.2188"	11.2"	5.9"	.47"	.55"	3MT
10"	3.6875"	12.9"	6.6"	.47"	.55"	3MT
12"	4.4375"	16.1"	8.2"	.55"	.70"	4MT

Accessories

	Contour Height		Model No.
	Min.	Max.	
Tailstocks for 10"	4.92"	7.30"	RTTS-10
Tailstocks for 12"	6.55"	8.97"	RTTS-12
Dividing Plates			DIP

Optional Accessories

Model No.	Description
DIP	Dividing Plate
RTTS-8/10	Adjustable Tailstock for 8 & 10"
RTTS-12	Adjustable Tailstock for 12"

Tolerances	Max. Vari. Inches
Flatness of clamping surface (concave)	0.0006"
Concentricity of cylindrical center bore	0.0008"
Concentricity of tapered center bore	0.0008"
Parallelism of clamping surface to base	0.0008"
Squareness of clamping surface to angle face	0.0004"
Squareness of clamping surface to center slot	0.0008"

Optional tailstock



Optional dividing plates

Milling and Drilling Tables

Features:

- Structural members are of fine-grain cast iron
 - All lead screws are 1/2" x 10" Acme thread
 - Easy to read, easy to set dials are calibrated in thousands of an inch
 - T-slots are 5/8" wide by 7/16" deep with an undercut to provide for T-nut hold down for fixtures jigs and other clamping devices
 - Small low silhouette table for light work.
- The Milling and Drilling table fastens quickly to drill-press table using central base bolt. With adjustable gibs



Height.....4-3/4"
 Base.....6-3/4"Dia. With 1-1/8"long bolt
 Width.....7"
 Depth.....7"
 Model No.: MDT-7/7/418

Table is rotatable 360°, locks by two set screws and internal locking shoes.
 Table travel 5" on either axis
 Weight 35 lbs.approx.

Swivel Angle Plates

- Adjustable
- Heavy castings and rugged construction
- Graduation in degrees in 0 to 90 ° range
- 2 Screw lock setting
- Saves setup time
- Machined T slots
- Precision made



Model No.	Size	Height	Weight
SA1	5 x 6"	4-1/2"	14 lbs.
SA2	6 x 8"	5"	26 lbs.
SA3	8 x 10"	6-1/2"	44 lbs.
SA4	10 x 12"	8"	66 lbs.

5C Fixture

5C collet is fit for this device, which can clamp tool or workpiece with different diameter and figure.

It can be fixed on lathe, milling machine, grinder, and other special equipment, with such features as high precision, easy operation, safe application, strong clamping, etc.

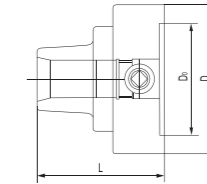

Model No.	Type	Clamping Range	D(mm)	Do(mm)	L(mm)
FIX5CR	Round	1~28mm	3/64"~1-1/8"		
FIX5CSQ	Square	3~19mm	1/8"~3/4"	126mm	95mm 107mm
FIX5CH	Hex	3~22mm	1/8"~7/8"		

Tilting Table

Features:

- Heavy machined casting
- Range 45° each way from vertical
- Table has clamping screws on each end
- 3 T Slots
- Calibrated on end
- Vernier graduation (5 Degrees)
- Low profile provides low machine-head clearance
- Worm gear



Model No.	Table Size	Height	T-Bolt Size	Weight
TT-5/7	5" x 7"	3-3/4"	1/2"	16 lbs.
TT-7/10	7" x 10"	5-1/2"	1/2"	41 lbs.
TT-10/15	10" x 15"	7-1/2"	1/2"	80 lbs.

Compound Slide Milling & Drilling Table

A heavy, rugged slide used in all kinds of positioning, milling, drilling, microscope viewing and staging. Adjustable bases for heavy loads, small jig boring, precision cut-off.

Model No.	Table Size	T-Slot Size	Height	Travel	Base Size
MDT-51212	5-1/2" x 12"	5/8"	4-1/2"	8" x 5"	9" x 8"
MDT-618	6" x 18"	5/8"	5"	13" x 6"	10-1/2" x 8"
MDT-1017	10" x 17"	5/8"	6"	6" x 9"	13-1/2" x 12"



MDT-51212

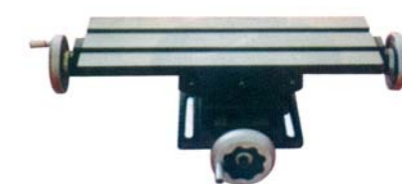

MDT-618



MDT-1017

