

Stub Milling Machine Arbor -R8 Shank

Model No.	Dia. of Arbor	Length of Shoulder to Nut
AR8ST-1	1"	2"
AR8ST-1-1/4	1-1/4"	2"



Stub Milling Machine Arbor-Straight Shank

For holding saws or small cutters. These arbors are designed and made to fit directly into standard End Mill Adaptors. Set includes spacers and nut. Arbors furnished with standard keyways and left Hand Arbor nut. Hardened and Ground.

Model No.	Arbor Diameter	Diameter of Straight Shank	Length of Shoulder to Nut
ASST-1/2	1/2	1/2	1"
ASST-5/8A	5/8	3/4	1"
ASST-3/4A	3/4	3/4	1"
ASST-1A	1"	3/4	1"
ASST-1-1/4A	1-1/4	3/4	1"



Morse Taper End Mill Holders

- Made of alloy steel for long, durable service life
- Hardened to RC 56-60 and ground to ensure maximum accuracy
- End mill socket T.I.R.<0.0004"



Tanged End Type A			Drawbar End Type B		
Model Type A	MT.NO.S	Bore	Model Type B	MT.NO.S	Bore
FD/2W-D	2	6-16mm	FD/2-D	2	6-16mm
FD/3W-D	3	6-25mm	FD/3-D	3	6-25mm
FD/4W-D	4	6-40mm	FD/4-D	4	6-40mm
FD/5W-D	5	6-50mm	FD/5-D	5	6-50mm
FD/6W-D	6	6-50mm	FD/6-D	6	6-50mm
FD/2W-DA	2	3/16 to 3/4"	FD/2-DA	2	3/16 to 3/4"
FD/3W-DA	3	3/16 to 1"	FD/3-DA	3	3/16 to 1"
FD/4W-DA	4	3/16 to 1-1/2"	FD/4-DA	4	3/16 to 1-1/2"
FD/5W-DA	5	3/16 to 2"	FD/5-DA	5	3/16 to 2"
FD/6W-DA	6	7/8 to 2-1/2"	FD/6-DA	6	7/8 to 2-1/2"

40 and 50 Standard Taper To R8 Adaptors

To adapt machine with 40 and 50 standard taper to R8 tooling.

Model No.	Outside Taper	Inside Taper
A40-R8	40	R8
A50-R8	50	R8



30-40-50 End Mill Holder

Model No.	Taper	Bore(in)	Model No.	Taper	Bore(mm)
EMH30-3/16	30	3/16"	EMH30-6	30	6
EMH30-3/8	Draw Bar	3/8"	EMH30-10	Draw Bar	10
EMH30-1/2	Thread	1/2"	EMH30-12	Thread	12
EMH30-5/8	1/4-20	5/8"	EMH30-16	1/4-20	16
EMH30-3/4		3/4"	EMH30-20		20
EMH30-1		1"	EMH30-25		25
EMH40-3/16	40	3/16"	EMH40-6	40	6
EMH40-3/8	Draw Bar	3/8"	EMH40-10	Draw Bar	10
EMH40-1/2"	Thread	1/2"	EMH40-12	Thread	12
EMH40-5/8"	5/8-11	5/8"	EMH40-16	5/8-11	16
EMH40-3/4		3/4"	EMH40-20		20
EMH40-1		1"	EMH40-25		25
EMH40-1-1/4		1-1/4"	EMH40-32		32
EMH40-1-1/2	50	1-1/2"	EMH40-40	50	40
EMH50-3/8	Draw Bar	3/8"	EMH50-6	Draw Bar	6
EMH50-1/2	Thread	1/2"	EMH50-12	Thread	12
EMH50-5/8	1"-8	5/8"	EMH50-16	1"-8	16
EMH50-3/4		3/4"	EMH50-20		20
EMH50-1		1"	EMH50-25		25
EMH50-1-1/4		1-1/4"	EMH50-32		32
EMH50-1-1/2		1-1/2"	EMH50-40		40
EMH50-2		2"	EMH50-50		50

30-40-50 Shell End Mill Holder

Model No.	Taper	Neck Diameter	Shell Mill Range in	Model No.	Taper	Neck Diameter	Shell Mill Range mm
EMS30-1/2	30	1/2	1-1/4 to 1-1/2	EMS30-13	30	13	32 to 38
EMS30-3/4		3/4	1-3/4 - 2	EMS30-20		20	45 - 50
EMS30-1		1	2-1/4 - 2-3/4	EMS30-25		25	58 - 70
EMS30-1-1/4		1-1/4	3-3-1/2	EMS30-32		32	76-89
EMS40-1/2	40	1/2	1-1/4 to 1-1/2	EMS40-13	40	13	32 to 38
EMS40-3/4		3/4	1-3/4 - 2	EMS40-20		20	45 - 50
EMS40-1		1	2-1/4 - 2-3/4	EMS40-25		25	58 - 70
EMS40-1-1/4		1-1/4	3-3-1/2	EMS40-32		32	76 - 89
EMS40-1-1/2		1-1/2	4-5	EMS40-38		38	102 - 127
EMS40-2		2	5-1/2-6	EMS40-50		50	140 - 152
EMS50-1/2	50	1/2	1-1/4 to 1-1/2	EMS50-13	50	13	32 to 38
EMS50-3/4		3/4	1-3/4-2	EMS50-20		20	45 - 50
EMS50-1		1	2-1/4 - 2-3/4	EMS50-25		25	58 - 70
EMS50-1-1/4		1-1/4	3-3-1/2	EMS50-32		32	76 - 89
EMS50-1-1/2		1-1/2	4-5	EMS50-38		38	102 - 127
EMS50-2		2	5-1/2-6	EMS50-50		50	140 - 152

Morse Taper Comb Shell End Mill Arbors

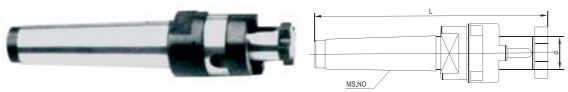

Model No.	Shank Taper	Arbor Dia. (in)	Model No.	Shank Taper	Arbor Dia. (mm)
SKMT3-1/2	MT3	1/2"	SKMT3-13	MT3	13
SKMT3-5/8	MT3	5/8"	SKMT3-16	MT3	16
SKMT3-3/4	MT3	3/4"	SKMT3-22	MT3	22
SKMT3-1	MT3	1"	SKMT3-27	MT3	27
SKMT3-1-1/4	MT3	1-1/4"	SKMT3-32	MT3	32
SKMT4-1/2	MT4	1/2"	SKMT4-13	MT4	13
SKMT4-5/8	MT4	5/8"	SKMT4-16	MT4	16
SKMT4-3/4	MT4	3/4"	SKMT4-22	MT4	22
SKMT4-1	MT4	1"	SKMT4-27	MT4	27
SKMT4-1-1/4	MT4	1-1/4"	SKMT4-32	MT4	32
SKMT4-1-1/2	MT4	1-1/2"	SKMT4-40	MT4	40
SKMT5-5/8	MT5	5/8"	SKMT5-16	MT5	16
SKMT5-3/4	MT5	3/4"	SKMT5-22	MT5	22
SKMT5-1	MT5	1"	SKMT5-27	MT5	27
SKMT5-1-1/4	MT5	1-1/4"	SKMT5-32	MT5	32
SKMT5-1-1/2	MT5	1-1/2"	SKMT5-40	MT5	40
SKMT5-2	MT5	2"	SKMT5-50	MT5	50

30-40-50 Comb Shell End Mill Arbors

Model No.			Arbor Dia. (in)
30	40	50	
SK30-1/2	SK40-1/2	SK50-1/2	1/2"
SK30-5/8	SK40-5/8	SK50-5/8	5/8"
SK30-3/4	SK40-3/4	SK50-3/4	3/4"
SK30-1	SK40-1	SK50-1	1"
SK30-1-1/4	SK40-1-1/4	SK50-1-1/4	1-1/4"
SK30-1-1/2	SK40-1-1/2	SK50-1-1/2	1-1/2"
SK30-2	SK40-2	SK50-2	2"

Model No.			Arbor Dia. (mm)
30	40	50	
SK30-13	SK40-13	SK50-13	13
SK30-16	SK40-16	SK50-16	16
SK30-27	SK40-27	SK50-27	27
SK30-32	SK40-32	SK50-32	32
SK30-40	SK40-40	SK50-40	40
SK30-50	SK40-50	SK50-50	50

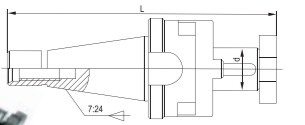

CAT40/CAT50 End Mill Holders

- For CNC machines having CAT40/CAT50 taper spindles.
- Hardened and precision ground.
- Retention knob thread: 5/8"-11.

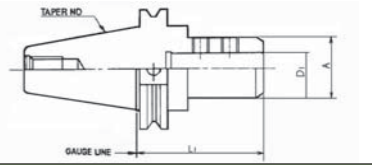

CAT40-Inch					CAT50-Inch									
Model No.	Taper	Size (D1)	L1	A	Model No.	Taper	Size (D1)	L1	A	Model No.	Taper	Size (D1)	L1	A
EHC40-3/16A	CAT40	3/16	2.50	.75	EHC40-5/8C	CAT40	5/8	5.00	1.50	EHC50-5/8B	CAT50	5/8	5.75	1.50
EHC40-3/16B		3/16	4.00	.75	EHC40-3/4A		3/4	1.75	1.75	EHC50-3/4A		3/4	3.75	1.75
EHC40-1/4A		1/4	2.50	.81	EHC40-3/4B		3/4	3.00	1.75	EHC50-3/4B		3/4	5.75	1.75
EHC40-1/4B		1/4	4.00	.81	EHC40-3/4C		3/4	5.00	1.75	EHC50-7/8A		7/8	3.75	2.00
EHC40-5/16A		5/16	2.50	1.00	EHC40-7/8A		7/8	3.50	2.00	EHC50-7/8B		7/8	5.75	2.00
EHC40-5/16B		5/16	4.00	1.00	EHC40-1A		1	1.75	1.75	EHC50-1A		1	4.00	2.25
EHC40-3/8A		3/8	2.50	1.00	EHC40-1-1/4A		1-1/4	2.00	2.25	EHC50-1B		1	6.00	2.25
EHC40-3/8B		3/8	4.00	1.00	EHC50-3/8A		3/8	2.50	1.00	EHC50-1C		1	8.00	2.25
EHC40-7/16	7/16	2.50	1.15	EHC50-3/8B	3/8	4.50	1.25	EHC50-1-1/4A	1-1/4	4.00	2.50			
EHC40-1/2A	1/2	1.75	1.25	EHC50-3/8C	3/8	6.00	1.50	EHC50-1-1/4B	1-1/4	6.00	2.50			
EHC40-1/2B	1/2	2.50	1.25	EHC50-1/2A	1/2	2.63	1.25	EHC50-1-1/4C	1-1/4	8.00	2.50			
EHC40-1/2C	1/2	4.00	1.25	EHC50-1/2B	1/2	4.63	1.25	EHC50-1-1/2A	1-1/2	4.00	2.75			
EHC40-5/8A	5/8	1.75	1.25	EHC50-1/2C	1/2	6.00	1.50	EHC50-1-1/2B	1-1/2	6.00	2.75			
EHC40-5/8B	5/8	3.00	1.50	EHC50-5/8A	5/8	3.75	1.50	EHC50-1-1/2C	1-1/2	8.00	2.75			

CAT Shell End Mill Holders

- For CNC machines having CAT40/CAT50 taper spindles.
- Hardened and precision ground.
- Retention knob thread: 5/8"-11.

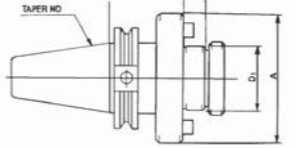

CAT40-Inch					
Model No.	Taper	Size (D1)	L1	H	A
SHC40-3/4A	CAT40	3/4	1.75	0.69	1.75
SHC40-3/4B		3/4	4.00	0.69	1.75
SHC40-1A		1"	2.50	0.69	2.25
SHC40-1B		1"	4.00	0.69	2.25
SHC40-1-1/4A		1-1/4	2.50	0.69	2.75
SHC40-1-1/4B		1-1/4	4.00	0.69	2.75
SHC40-1-1/2A		1-1/2	2.50	0.69	3.82
SHC40-1-1/2B		1-1/2	4.00	0.69	3.82

CAT50-Inch					
Model No.	Taper	Size (d)	L1	H	A
SHC40-1-1/4B	CAT40	1-1/4	4.50	0.69	2.75
SHC40-1-1/2A		1-1/2	2.50	0.94	3.82
SHC40-1-1/2B		1-1/2	4.00	0.94	3.82
SHC50-3/4A		3/4	1.50	0.69	1.75
SHC50-3/4B		3/4	3.50	0.69	1.75
SHC50-1A		1"	2.00	0.69	2.25
SHC50-1B		1"	4.00	0.69	2.25
SHC50-1-1/4A		1-1/4	1.50	0.69	2.75
SHC50-1-1/4B	CAT50	1-1/4	3.50	0.69	2.75
SHC50-1-1/2A		1-1/2	2.40	0.94	3.82
SHC50-1-1/2B		1-1/2	4.00	0.94	3.82
SHC50-2A		2"	2.40	0.94	4.13
SHC50-2B		2"	4.00	0.94	4.13
SHC50-2-1/2A		2-1/2	2.40	1.13	5.06
SHC50-2-1/2B		2-1/2	4.00	1.13	5.06

ER Precision Collet Chucks

